

**ThermaCELL®**

# HOLSTER™

*The “no-hands” way to transport and secure ThermaCELL® and ThermaSCENT™ appliances*

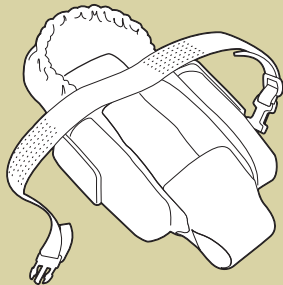

THE SCHAWBEL CORPORATION  
26 Crosby Drive  
Bedford, MA 01730  
www.thermacell.com

## DIRECTIONS:

- 1 Check butane level in your ThermaCELL or ThermaSCENT appliance. Insert new cartridge if needed.
- 2 Slide narrow end of ThermaCELL appliance into the very bottom of Holster sleeve.
- 3 Make sure that Holster straps are directly below the grill.
- 4 Pull “hood” of Holster up over wide end of appliance. Ensure that Holster is not covering the grill. Line up the round hole on the hood with the appliance’s ignition viewing light.
- 5 Insert new mat if needed. Insert spare cartridge and mats in Holster side pouches if desired.
- 6 To change butane cartridge, simply undo snaps near the narrow end of the Holster. Remove appliance end cap. Unscrew cartridge and replace with a new one. Replace end cap. Snap Holster bottom back into place.

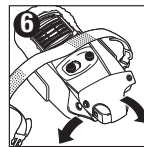
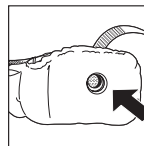
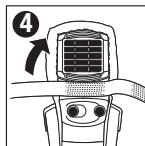
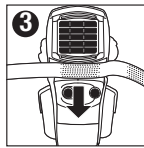
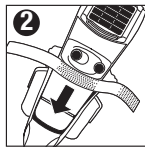

## Proper Use of Holster and Appliance

■ When transporting your ThermaCELL appliance to or from your hunting, fishing or camping site, you will find the Holster handy as the straps allow you to attach the product to your pack or belt. Do not, however, turn the ThermaCELL appliance on while it is being transported. The useful life of your appliance will be shortened if it is used in this manner.

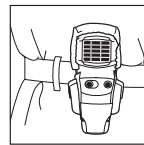

■ Once you’ve arrived at your site, re-adjust the Holster’s straps as needed in order to secure your appliance to a stable, horizontal surface such as a tree stand or tree limb. The appliance may then be turned on and used as long as the grill is facing up. Do not mount or hang the appliance vertically while in use. This will shorten the useful life of the appliance.

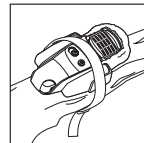

■ Make sure that vents on the bottom of the appliance are exposed. ThermaCELL needs airflow from vents to work properly.



■ Do not let the Holster cover any part of ThermaCELL’s grill. Grill will get HOT quickly.